

Tee (Reducing)

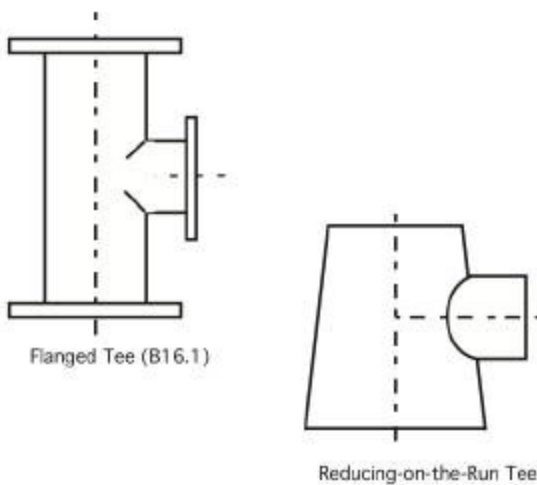

SIZE (IPS/OD)	DIMENSIONS (B16.9)	
	A	B
2 x 1-1/2	2-1/2	2-3/8
2 x 1-1/4	2-1/2	2-1/4
2 x 1	2-1/2	2
2-1/2 x 2	3	2-3/4
2-1/2 x 1-1/2	3	2-5/8
2-1/2 x 1-1/4	3	2-1/2
2-1/2 x 1	3	2-1/4
3 x 2-1/2	3-3/8	3-1/4
3 x 2	3-3/8	3
3 x 1-1/2	3-3/8	2-7/8
3 x 1-1/4	3-3/8	2-3/4
3 x 1	3-3/8	2-5/8
4 x 3	4-1/8	3-7/8
4 x 2-1/2	4-1/8	3-3/4
4 x 2	4-1/8	3-1/2
4 x 1-1/2	4-1/8	3-3/8
5 x 4	4-7/8	4-5/8
5 x 3	4-7/8	4-3/8
5 x 2-1/2	4-7/8	4-1/4
5 x 2	4-7/8	4-1/8
5 x 1-1/2	4-7/8	
6 x 5	5-5/8	5-3/8
6 x 4	5-5/8	5-1/8
6 x 3	5-5/8	4-7/8
6 x 2-1/2	5-5/8	4-3/4
6 x 2	5-5/8	4-5/8
8 x 6	7	6-5/8
8 x 5	7	6-3/8
8 x 4	7	6-1/8
8 x 3	7	5-7/8
10 x 8	8-1/2	8
10 x 6	8-1/2	7-5/8
10 x 5	8-1/2	7-1/2
10 x 4	8-1/2	7-1/4
10 x 3	8-1/2	7
12 x 10	10	9-1/2
12 x 8	10	9
12 x 6	10	8-5/8

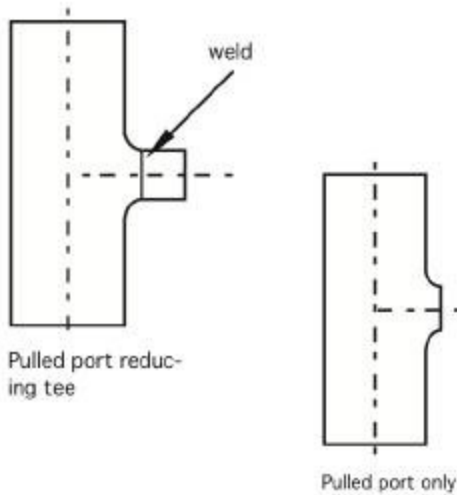
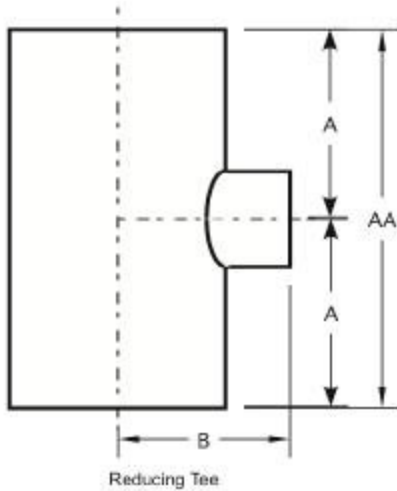
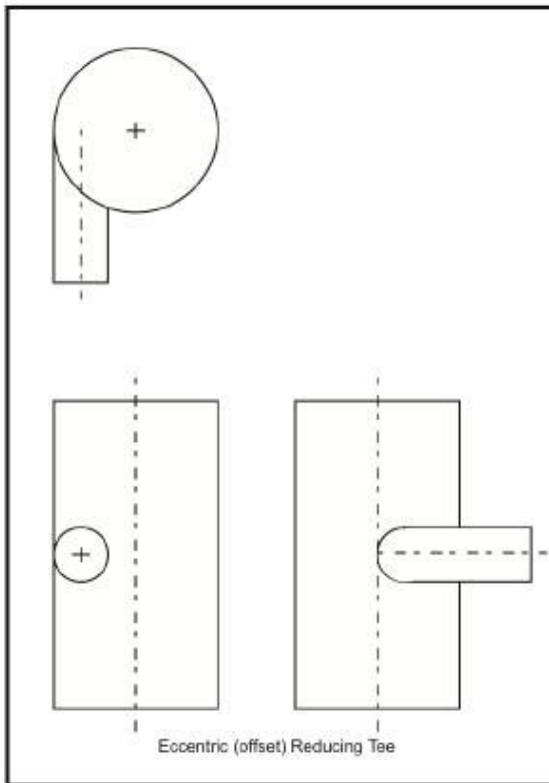
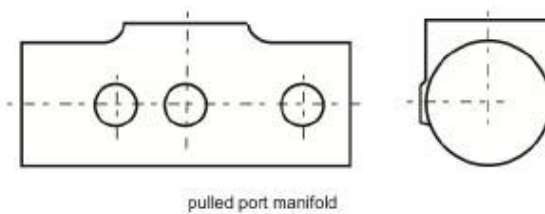
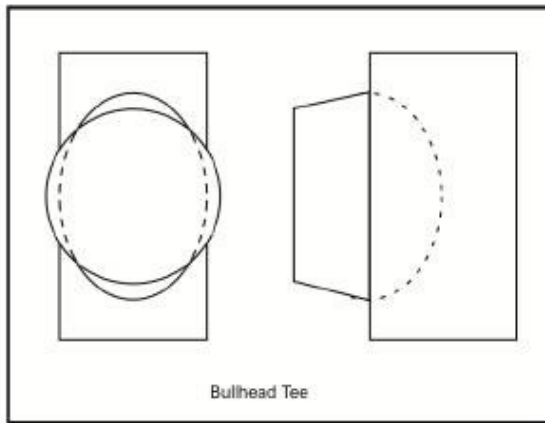

12 x 5	10	8-1/2
12 x 4	10	8-1/4
14 x 12	11	10-5/8
14 x 10	11	10-1/8
14 x 8	11	9-3/4
14 x 6	11	9-3/8
16 x 14	12	12
16 x 12	12	11-5/8
16 x 10	12	11-1/8
16 x 8	12	10-3/4
16 x 6	12	10-3/8
18 x 16	13-1/2	13
18 x 14	13-1/2	13
18 x 12	13-1/2	12-5/8
18 x 10	13-1/2	12-1/8
18 x 8	13-1/2	11-3/4
20 x 18	15	14-1/2
20 x 16	15	14
20 x 14	15	14
20 x 12	15	13-5/8
20 x 10	15	13-1/8
20 x 8	15	12-3/4
22 x 20	16-1/2	16
22 x 18	16-1/2	15-1/2
22 x 16	16-1/2	15
22 x 14	16-1/2	15
22 x 12	16-1/2	14-5/8
24 x 22	17	17
24 x 20	17	17
24 x 18	17	16-1/2
24 x 16	17	16
24 x 14	17	16
24 x 12	17	15-5/8
24 x 10	17	15-1/8
30 x 24	22	21
30 x 22	22	20-1/2
30 x 20	22	20
30 x 18	22	19-1/2
30 x 16	22	19
36 x 30	26-1/2	25
36 x 24	26-1/2	24
36 x 20	26-1/2	23
36 x 18	26-1/2	22-1/2

- Manufactured to the specs and tolerances of ASTM A774.
- Custom dimensions available upon request.
- Available in 304L, 316L, 317L; other materials upon request.
- Available ends for B16.9: butt weld or beveled.
- Available ends for B16.1: butt weld, beveled, grooved, flanged, or Van Stone.